

# PLAT OF SURVEY

A PARCEL OF LAND BEING SITUATED IN THE SOUTHWEST QUARTER, SECTION 32, TOWNSHIP 8 NORTH, RANGE 4 EAST, BRADY TOWNSHIP, WILLIAMS COUNTY, OHIO. LOCATED WITHIN THE NORTH AND EAST OF THE FIRST PRINCIPAL MERIDIAN OF THE ORIGINAL LAND SUBDIVISIONS OF OHIO.

SURVEYED FOR:  
NICHOLAS SMITH

NICHOLAS G. SMITH  
DEED VOL. 352 PAGE 1406

DAVID B. AND KELLY L. COLON  
DEED VOL. 343 PAGE 2479

RICHARD L. SMITH  
DEED VOL. 308 PAGE 909

0.798 ACRES  
EXIST. BLDGS

REFERENCE SURVEYS:  
VOL. 10R PG. 177  
VOL. 12R PG. 215  
VOL. 14R PG. 255

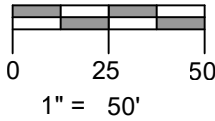

W. LINE SECT. 32

SW CORNER  
SECTION 32

N89° 01' 01"W 19.80'

N89° 01' 01"W  
1302.93'

NW CORNER  
SECTION 5

SOUTH LINE SECTION 32

W. LINE, E. HALF, SW QTR. SECT. 32

N89° 01' 01"W  
463.00'

N00° 58' 59"E 366.00'

262.60'

20.00'

COUNTY ROAD M

N89° 01' 01"W 95.00'

20.00'

S89° 01' 01"E 2087.46'

SW CORNER,  
E1/2, SE1/4  
SECTION 32

E. LINE, W. HALF, SE QTR. SECT. 32

S00° 58' 59"W 366.00'

S89° 01' 01"E 95.00'

83.40'

I HEREBY CERTIFY THAT I HAVE SURVEYED THE PREMISES SHOWN ON THE PLAT ABOVE. ALL DIMENSIONS ARE SHOWN IN FEET AND DECIMALS THEREOF. SINCE THIS SURVEY DOES NOT INCLUDE A TITLE SEARCH, THERE COULD BE EASEMENTS OR OTHER ENCUMBRANCES UPON THE LAND WHICH ARE NOT SHOWN ON THIS SURVEY PLAT. IF THESE ARE REQUIRED, PLEASE FURNISH THE NECESSARY INFORMATION. THE BEARINGS SHOWN ON THE PLAT ABOVE ARE BASED ON STATE PLANE COORDINATES, SPC83, ZONE-OHIO NORTH. THIS SURVEY HAS BEEN RECORDED IN VOL. 28R PAGE 468 OF THE WILLIAMS COUNTY SURVEY RECORDS.

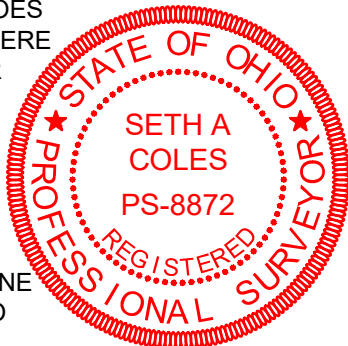

GENERAL NOTATION OF OCCUPATION  
ALL LINES OF OCCUPATION WERE LAWN. NO VISIBLE FENCES EXISTED ALONG ANY BOUNDARIES OF THIS PROPERTY.

## LEGEND

- PLACED 5/8" REBAR W/CAP (COLES 8872)
- FOUND IRON PIN OR PIPE (CIP-CAPPED IRON PIN)
- ⊠ FOUND MONUMENT BOX
- × FOUND P.K. NAIL
- POINT ESTABLISHED THIS SURVEY
- (R) RECORDED DISTANCE FROM DEED.
- (M) MEASURED DISTANCE THIS SURVEY

JOB NO: 24-008

DATE: 04-15-2024

**ON TARGET**



2312 County Road 2L  
Edon, OH 43518  
(419) 633-2975  
ontargetengr.com

*Seth A. Coles*

SETH A. COLES  
REGISTERED SURVEYOR NO. 8872